

FIBREGLASS TROUGH URINAL FG-1200

REV.	DESCRIPTION	DATE

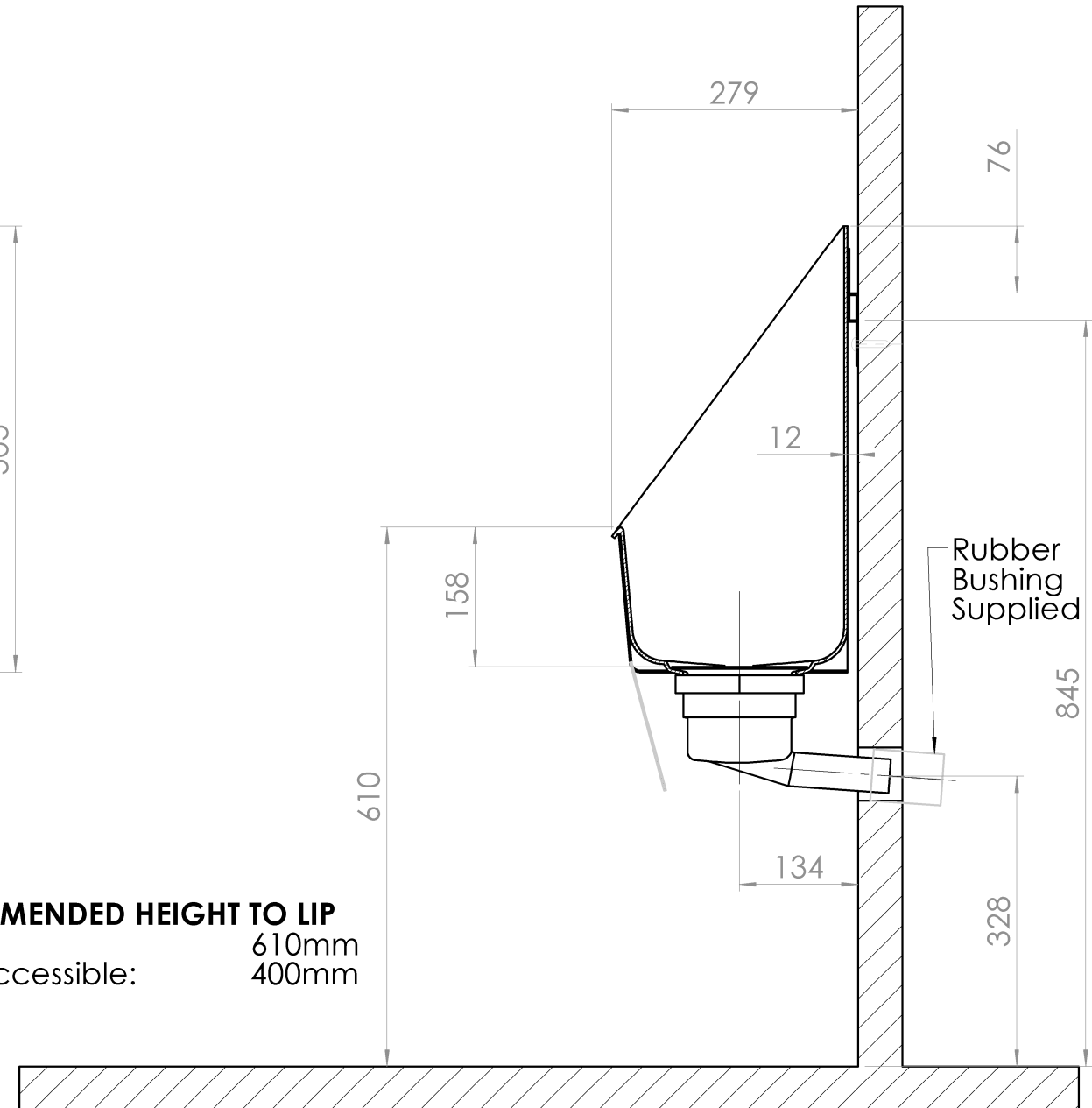
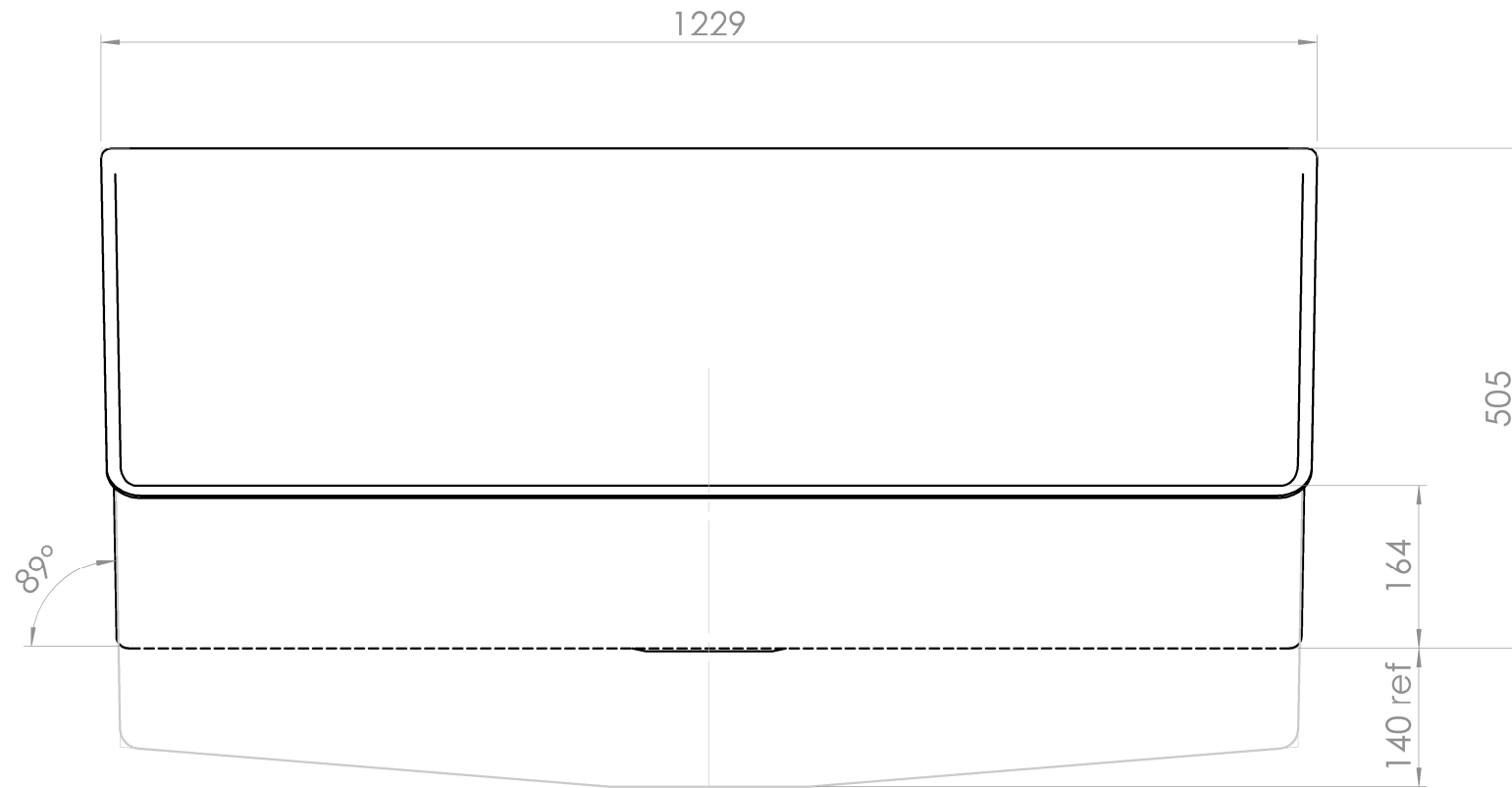

RECOMMENDED HEIGHT TO LIP
 Men: 610mm
 Boys/Accessible: 400mm

WARNING
 THIS URINAL MUST BE CONNECTED DIRECTLY TO PVC OR BRASS TUBING, NOT COPPER. THE MANUFACTURER AND DISTRIBUTOR TAKE NO RESPONSIBILITY FOR DAMAGE DUE TO COPPER CORROSION.



MATERIAL	TITLE		DESIGNED FOR SOUTH PACIFIC WATERLESS LTD BY ACS DESIGN Ph. (07) 377 0675
FINISH FREE OF SHARP EDGES	TWO MAN URINAL INSTALLATION		
GEN. TOL ± 0.02	DRAWN N. ALLEN	DO NOT SCALE OFF DRAWING IF IN DOUBT, ASK	DWG. NO. ACS 1035 SHT 1 OF 1
	DATE 2 JULY 2008	ALL DIMENSIONS IN MILLIMETRES	SHEET REV. No.
	SCALE 1:7.5	THIRD ANGLE PROJECTION	SIZE A3